



Craig Finger
Director of Bands
craigfinger@nixaschools.net

Kim Martin
Assistant Director
kimmartin@nixaschools.net

Ruth Sorenson
Assistant Director
ruthsorenson@nixaschools.net

Mary Duerkop
Assistant Director
maryduerkop@nixaschools.net

Erika O'Bryant
Assistant Director
erikaobryant@nixaschools.net

Kirby Spayde
Assistant Director
kirbyspayde@nixaschools.net

Mailing Address: 301 S. Main Street Nixa, MO 65714 HS: 417.724.3550 JH: 417.875.5473 @nixabands

Dear Winter Guard Instructors:

We are looking forward to you and your students attending the Nixa Winter Guard festival on March 7. We think that once you arrive you will find that it is an excellent facility to house such an event. Our entire purpose is to provide the attending units with a relaxed, fun, and educational experience. If there is anything that we can do to make your day go smoother, please let us know.

DIRECTIONS TO NIXA HS...

From Springfield: Go south on Campbell (HW 160), turn right (west) on Mt. Vernon (HW 14), turn left (south) on Nicholas (HW M), the HS will be on your left about a 1/2 a mile down.

We are extremely proud of our facility and ask your help in reminding your members and crews that we would like to keep it in excellent condition. There should be absolutely no spinning, tossing or playing of any equipment in the school except in the equipment warm-up room and performance area. We also ask that the crews be careful moving props so walls and doors are not damaged. We reserve the right to refuse any equipment that may cause damage to our facility. PLEASE NOTE the item detailed on the following page regarding construction on our campus.

There will be concessions available and we hope that you encourage your students to browse through and support our band boosters. Obviously one the reasons that we host a festival is to utilize the fundraising opportunities to help support the program. Our kids and parents will work hard to make the day pleasant for you so I hope you consider rewarding them by being patron of our concessions. Outside food and drink cannot be brought into the building so please share this with your parents.

Again, we are looking forward to having you visit us at Nixa. If there is anything that we can do to make your day easier, please feel free to contact us.

Sincerely,

Craig Finger, Director of Bands
Nixa Public Schools

Nixa Winter Guard and Percussion Festival
March 7, 2020

Location: Nixa HS, 514 S. Nicholas, Nixa

Construction: The southeastern part of our campus near the football stadium is currently under construction. The driving flow from bus and trailer unloading to loading can only take place on the north side of the building. There is an included map for details but in general you can plan on unloading on the west side of the building, driving around the north side and then parking and loading on the east side of the building. When loading your students following awards please walk to your buses and do not bring them down to the curb to pick up. This creates congestion for our spectators who are also trying to leave.

Unit Check-In: Units will check in at the main entrance on the west side of the building. The doors are located under the "Nixa High School" sign and awning. Unit members, one director (with badge) and 7 additional people will be admitted. Additional staff/crew/drivers **MUST** purchase tickets. Your group can check in any time after 8:30 AM. **Please don't plan on arriving before 8:30 AM.** (Please take note of equipment check in the full schedule). **UNIT MEMBERS AND STAFF MUST CHECK IN TOGETHER.** (Performers will be stamped and the additional 7 will be given wristbands). We will have building guides ready to show you to your storage area as well as point out key locations in the contest flow.

Dressing Facilities: Available on site, 2nd floor. Again, remind students to be responsible and to take care of their personal items. MCCA and Nixa Schools will not be responsible for lost or stolen items.

Storage: All units will have an area assigned to them for personal (bags, flags, rifles) storage. You can bring equipment (props, tarps) into the building at the designated time (see schedule) and then all equipment must be removed following your units performance. Refolding of tarps will be done inside the band room. We ask that you move quickly following your performance as the next group will be following close behind.

PLEASE NOTE: Per school policy, no outside food or drink is to be brought into the building and Nixa HS is a smoke free **CAMPUS** (not just building).

Footwear and Equipment Protection: All equipment tips on rifles, poles, and sabres must be padded and taped. Any questionable equipment will not be allowed on the performance floor. **THIS WILL BE STRICTLY ENFORCED!** Hard soled shoes will need to be taped before your performance. All stands need to have the proper footing or be taped. Cart wheels must be in "indoor" condition.

Parking and Unloading of Performers and Equipment: Students can be dropped off in the circle drive in front of the main entrance. Buses and equipment trucks should park on the east side of the building in the upper parking lot), north of the stadium. Equipment trucks may move around to the front of the building at your equipment check in time. Please then move your vehicle to the designated parking area. Following your performance, your equipment vehicles can move down close to the building to load and then please move back to the designated parking area. PLEASE do NOT park buses or equipment vehicles in spectator parking. They take up too much space and also can easily get blocked in to where you can't get out when needed. We ask the trailers be considerate of the need to utilize parking effectively and not take more space than needed.

Tabulating and Judging Area: These areas are off limits to everyone except authorized personnel.

Floor Size: There is ample room on both ends of the performance area as well as in the back. The doors entering and exiting the performance floor are double doors with no middle bar (72"), but there are doors leading into the hallway that are only 60". If you need anything wider please contact me prior to your performance so we can make arrangements. **PLEASE NOTE:** Guards will enter from the performers back left and exit to the performers back right.

Timing and Time Line: Please have plenty of help to move your equipment, especially percussion. We will be using a vertical timing line.

Music/MP3: Bring music to the sound table prior to your performance. **It is the director's responsibility to get your music to the sound table.** Sound testing can take place during breaks. Please have a back up of a different media type in case there are any problems with the player reading your CD. It is recommended that a representative of your guard stay at the sound table during your unit's performance. If you use an MP3 player as your sound a member of your staff will be required to actually run the device.

Warm-Up Area: A sound system will not be available in the warm up area so you should plan on bringing your own. Guards will have warm-up in the auxiliary gym and will have the entire warm up time in one area. The space available to each group is half of the gym floor, even if you are the only group in the room at the time. You should only use your music during the last half of your warm time and always be considerate of the volume. You should stage yourself so the music is not facing the other unit in the gym. Please note that your warm up time includes set up and tear down. You need to be clear of the room by the end of your warm up time.

ALL PERFORMING ENSEMBLES: The warm up rooms will be adequate for body warm up as well music/equipment warm up. There will not be enough space for you to run your show visually. Please plan accordingly.

Maps: I have made some helpful notes on the maps. Simply click or hover your mouse over the yellow callout.

Critique: MCCGA will publish a schedule for those who pre-registered for critique, which can be found on the MCCGA Directors Page.

Competition Suites: All MCCGA festivals will use *Competition Suites* for tabulation purposes and commentary processing. You will be provided with an access code to *Competition Suites* where you will be able to access your judges commentary on your cell phone, laptop, etc. Also through *Competition Suites* you will be able to access recaps from the festival once they are processed and posted.

Spectator Admission: \$7 per person, \$5 for students (ages 5-18) and seniors (60+), and children 5 and under are no charge.

Concessions: The Nixa band boosters will be selling food items such as pizza, nachos, BBQ Pork sandwiches, pretzels, chips, candy, and drinks.

Contacts:

Craig Finger, Director of Bands (417) 844-8387

Mary Duerkop, Asst. Director (623) 693-1153

Kim Martin, Asst. Director (417) 299-5794

Erika O'Bryant, Asst. Director (417) 234-4860

Kirby Spayde, Asst. Director (816) 565-1148



Craig Finger
Director of Bands
craigfinger@nixaschools.net

Kim Martin
Assistant Director
kimmartin@nixaschools.net

Ruth Sorenson
Assistant Director
ruthsorenson@nixaschools.net

Mary Duerkop
Assistant Director
maryduerkop@nixaschools.net

Erika O'Bryant
Assistant Director
erikaobryant@nixaschools.net

Kirby Spayde
Assistant Director
kirbyspayde@nixaschools.net

Mailing Address: 301 S. Main Street Nixa, MO 65714 HS: 417.724.3550 JH: 417.875.5473 @nixabands

Dear Winter Guard Instructors:

We are looking forward to you and your students attending the Nixa Winter Guard festival on March 7. We think that once you arrive you will find that it is an excellent facility to house such an event. Our entire purpose is to provide the attending units with a relaxed, fun, and educational experience. If there is anything that we can do to make your day go smoother, please let us know.

DIRECTIONS TO NIXA HS...

From Springfield: Go south on Campbell (HW 160), turn right (west) on Mt. Vernon (HW 14), turn left (south) on Nicholas (HW M), the HS will be on your left about a 1/2 a mile down.

We are extremely proud of our facility and ask your help in reminding your members and crews that we would like to keep it in excellent condition. There should be absolutely no spinning, tossing or playing of any equipment in the school except in the equipment warm-up room and performance area. We also ask that the crews be careful moving props so walls and doors are not damaged. We reserve the right to refuse any equipment that may cause damage to our facility. PLEASE NOTE the item detailed on the following page regarding construction on our campus.

There will be concessions available and we hope that you encourage your students to browse through and support our band boosters. Obviously one the reasons that we host a festival is to utilize the fundraising opportunities to help support the program. Our kids and parents will work hard to make the day pleasant for you so I hope you consider rewarding them by being patron of our concessions. Outside food and drink cannot be brought into the building so please share this with your parents.

Again, we are looking forward to having you visit us at Nixa. If there is anything that we can do to make your day easier, please feel free to contact us.

Sincerely,

Craig Finger, Director of Bands
Nixa Public Schools

Nixa Winter Guard and Percussion Festival
March 7, 2020

Location: Nixa HS, 514 S. Nicholas, Nixa

Construction: The southeastern part of our campus near the football stadium is currently under construction. Please note the map for parking flow for both your buses and trailers.

Unit Check-In: Units will check in at the main entrance on the west side of the building. The doors are located under the "Nixa High School" sign and awning. Unit members, one director (with badge) and 7 additional people will be admitted. Additional staff/crew/drivers **MUST** purchase tickets. Your group can check in any time after 8:30 AM. **Please don't plan on arriving before 8:30 AM.** (Please take note of equipment check in the full schedule). UNIT MEMBERS AND STAFF MUST CHECK IN TOGETHER. (Performers will be stamped and the additional 7 will be given wristbands). We will have building guides ready to show you to your storage area as well as point out key locations in the contest flow.

Dressing Facilities: Available on site, 2nd floor. Again, remind students to be responsible and to take care of their personal items. MCCGA and Nixa Schools will not be responsible for lost or stolen items.

Storage: All units will have an area assigned to them for personal (bags, flags, rifles) storage. You can bring equipment (props, tarps) into the building at the designated time (see schedule) and then all equipment must be removed following your units performance. Refolding of tarps will be done inside the band room. We ask that you move quickly following your performance as the next group will be following close behind.

PLEASE NOTE: Per school policy, no outside food or drink is to be brought into the building and Nixa HS is a smoke free **CAMPUS (not just building)**.

Footwear and Equipment Protection: All equipment tips on rifles, poles, and sabres must be padded and taped. Any questionable equipment will not be allowed on the performance floor. **THIS WILL BE STRICTLY ENFORCED!** Hard soled shoes will need to be taped before your performance. All stands need to have the proper footing or be taped. Cart wheels must be in "indoor" condition.

Parking and Unloading of Performers and Equipment: Students can be dropped off in the circle drive in front of the main entrance. Buses and equipment trucks should park on the east side of the building in the upper parking lot, north of the stadium. Equipment trucks may move around to the front of the building at your equipment check in time. Please then move your vehicle to the designated parking area. Following your performance, your equipment vehicles can move down close to the building to load and then please move back to the designated parking area. **PLEASE** do NOT park buses or equipment vehicles in spectator parking. They

take up too much space and also can easily get blocked in to where you can't get out when needed. We ask the trailers be considerate of the need to utilize parking effectively and not take more space than needed.

Tabulating and Judging Area: These areas are off limits to everyone except authorized personnel.

Floor Size: There is ample room on both ends of the performance area as well as in the back. The doors entering and exiting the performance floor are double doors with no middle bar (72"), but there are doors leading into the hallway that are only 60". If you need anything wider please contact me prior to your performance so we can make arrangements. **PLEASE NOTE: Guards** will enter from the performers back left and exit to the performers back right.

Timing and Time Line: Please have plenty of help to move your equipment, especially percussion. We will be using a vertical timing line.

Music/MP3: Bring music to the sound table prior to your performance. **It is the director's responsibility to get your music to the sound table.** Sound testing can take place during breaks. Please have a back up of a different media type in case there are any problems with the player reading your CD. It is recommended that a representative of your guard stay at the sound table during your unit's performance. If you use an MP3 player as your sound a member of your staff will be required to actually run the device.

Warm-Up Area: A sound system will not be available in the warm up area so you should plan on bringing your own. Guards will have warm-up in the auxiliary gym and will have the entire warm up time in one area. The space available to each group is half of the gym floor, even if you are the only group in the room at the time. You should only use your music during the last half of your warm time and always be considerate of the volume. You should stage yourself so the music is not facing the other unit in the gym. Please note that your warm up time includes set up and tear down. You need to be clear of the room by the end of your warm up time.

ALL PERFORMING ENSEMBLES: The warm up rooms will be adequate for body warm up as well music/equipment warm up. There will not be enough space for you to run your show visually. Please plan accordingly.

Maps: I have made some helpful notes on the maps. Simply click or hover your mouse over the yellow callout. A reminder that there is a different flow for percussion and guard so take care to study the appropriate map.

Critique: MCCGA will publish a schedule for those who pre-registered for critique, which can be found on the MCCGA Directors Page.

Competition Suites: All MCCGA festivals will use *Competition Suites* for tabulation purposes and commentary processing. You will be provided with an access code to *Competition Suites* where you will be able to access your judges commentary on your cell phone, laptop, etc. Also

through *Competition Suites* you will be able to access recaps from the festival once they are processed and posted.

Spectator Admission: \$7 per person, \$5 for students (ages 5-18) and seniors (60+), and children 5 and under are no charge.

Concessions: The Nixa band boosters will be selling food items such as pizza, nachos, BBQ Pork sandwiches, pretzels, chips, candy, and drinks.

Contacts:

Craig Finger, Director of Bands (417) 844-8387

Mary Duerkop, Asst. Director (623) 693-1153

Kim Martin, Asst. Director (417) 299-5794

Erika O'Bryant, Asst. Director (417) 234-4860

Kirby Spayde, Asst. Director (816) 565-1148

Guard Flow

514 Nicholas Road

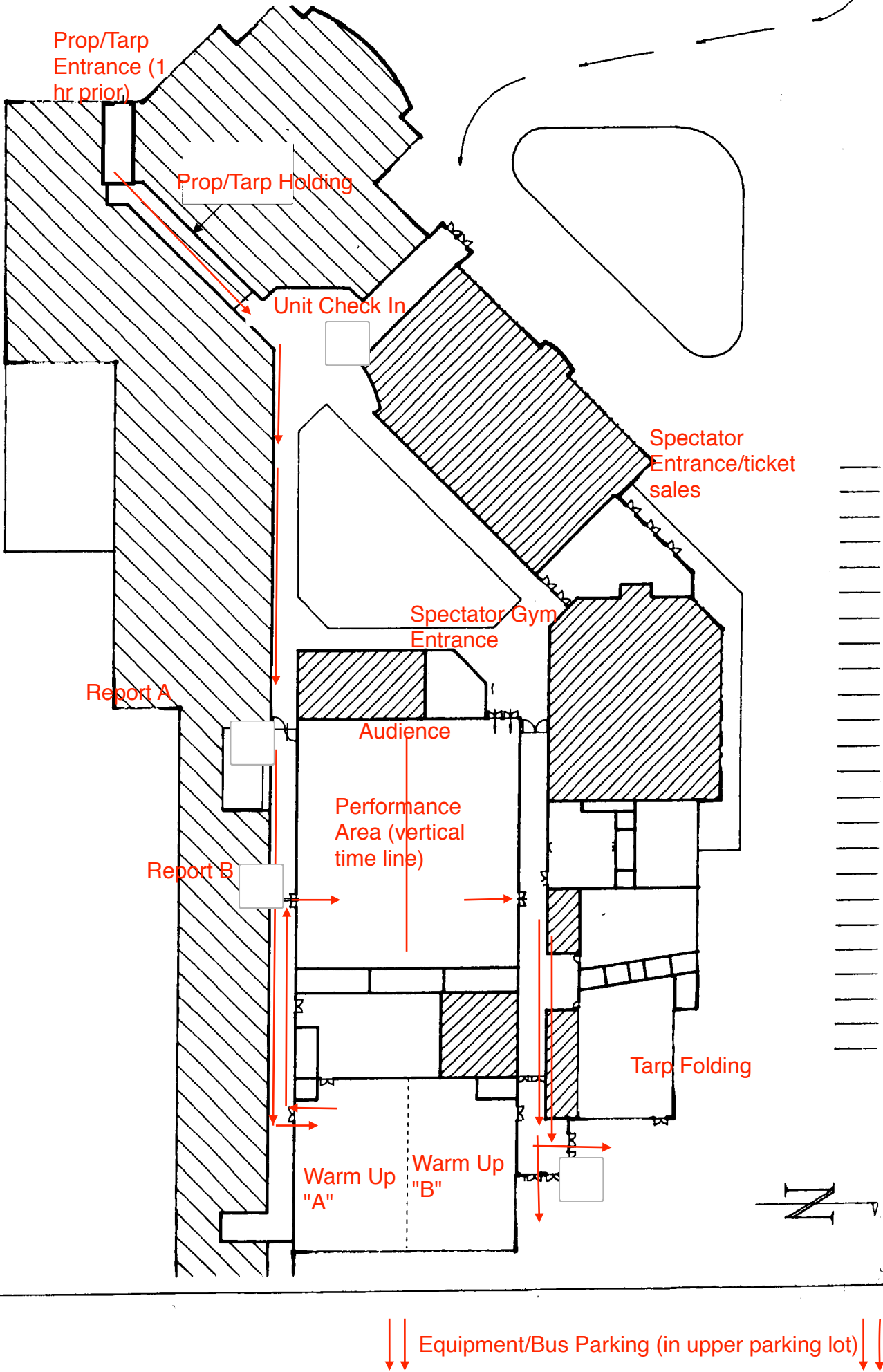

MARCH 7 - NIXA

Nixa Winter Guard Festival										
Unit	Classification	EQUIP CK IN	ESCORT	WARM UP	PROP REPORT	REPORT	Perform			
Nixa Junior High	Sch Cadet	9:00 AM	9:27 AM	9:37-9:51 AM	9:46 AM	9:53 AM	10:00 AM			
BREAK							10:07 AM			
Southern Boone County HS	Sch Reg A	9:14 AM	9:41 AM	9:51-10:05 AM	10:00 AM	10:07 AM	10:14 AM			
Branson HS	Sch Reg A	9:21 AM	9:48 AM	9:58-10:12 AM	10:07 AM	10:14 AM	10:21 AM			
Bryant HS	Sch Reg A	9:28 AM	9:55 AM	10:05-10:19 AM	10:14 AM	10:21 AM	10:28 AM			
Rock Bridge HS	Sch Reg A	9:35 AM	10:02 AM	10:12-10:26 AM	10:21 AM	10:28 AM	10:35 AM			
Joplin HS Winter Guard	Sch Reg A	9:42 AM	10:09 AM	10:19-10:33 AM	10:28 AM	10:35 AM	10:42 AM			
Hillcrest HS	Sch Reg A	9:49 AM	10:16 AM	10:26-10:40 AM	10:35 AM	10:42 AM	10:49 AM			
St. Clair HS	Sch Reg A	9:56 AM	10:23 AM	10:33-10:47 AM	10:42 AM	10:49 AM	10:56 AM			
BREAK							11:03 AM			
Baptist Preparatory School	Sch Reg A	10:17 AM	10:44 AM	10:54-11:08 AM	11:03 AM	11:10 AM	11:17 AM			
Reeds Spring HS	Sch Reg A	10:24 AM	10:51 AM	11:01-11:15 AM	11:10 AM	11:17 AM	11:24 AM			
Glendale HS	Sch Reg A	10:31 AM	10:58 AM	11:08-11:23 AM	11:17 AM	11:24 AM	11:31 AM			
Mountain Home HS	Sch Reg A	10:38 AM	11:05 AM	11:15-11:29 AM	11:24 AM	11:31 AM	11:38 AM			
Harrisonville HS	Sch Reg A	10:45 AM	11:12 AM	11:22-11:36 AM	11:31 AM	11:38 AM	11:45 AM			
St. James HS	Sch Reg A	10:52 AM	11:19 AM	11:29-11:43 AM	11:38 AM	11:45 AM	11:52 AM			
Lindbergh HS	Sch Reg A	10:59 AM	11:26 AM	11:36-11:50 AM	11:45 AM	11:52 AM	11:59 AM			
Clever HS	Sch Reg A	11:06 AM	11:33 AM	11:43-11:57 AM	11:52 AM	11:59 AM	12:06 PM			
Fusion Winter Guard	Ind Reg A	11:13 AM	11:40 AM	11:50-12:04 AM	11:59 AM	12:06 PM	12:13 PM			
LUNCH BREAK							12:20 PM			
Ozark HS Varsity	Sch AA	12:08 PM	12:32 PM	12:42-12:58 PM	12:52 PM	1:00 PM	1:08 PM			
Republic HS	Sch AA	12:16 PM	12:40 PM	12:50-1:06 PM	1:00 PM	1:08 PM	1:16 PM			
BREAK							1:24 PM			
Nixa HS	Sch A	12:34 PM	12:56 PM	1:06-1:22 PM	1:16 PM	1:24 PM	1:34 PM			
Willard HS	Sch A	12:42 PM	1:04 PM	1:14-1:30 PM	1:24 PM	1:34 PM	1:42 PM			
BREAK							1:50 PM			
Spintronix Indoor Guard	Ind A	1:00 PM	1:22 PM	1:32-1:48 PM	1:42 PM	1:50 PM	2:00 PM			
901 Performance Ensemble	Ind A	1:08 PM	1:30 PM	1:40-1:56 PM	1:50 PM	2:00 PM	2:08 PM			
ALL CLASS RETREAT							2:30 PM			
ALL CLASS CRITIQUE							2:40 PM			

through *Competition Suites* you will be able to access recaps from the festival once they are processed and posted.

Spectator Admission: \$7 per person, \$5 for students (ages 5-18) and seniors (60+), and children 5 and under are no charge.

Concessions: The Nixa band boosters will be selling food items such as pizza, nachos, BBQ Pork sandwiches, pretzels, chips, candy, and drinks.

Contacts:

Craig Finger, Director of Bands (417) 844-8387

Mary Duerkop, Asst. Director (623) 693-1153

Kim Martin, Asst. Director (417) 299-5794

Erika O'Bryant, Asst. Director (417) 234-4860

Kirby Spayde, Asst. Director (816) 565-1148