

Blue Springs South High School
1200 SE Adams Dairy PKWY

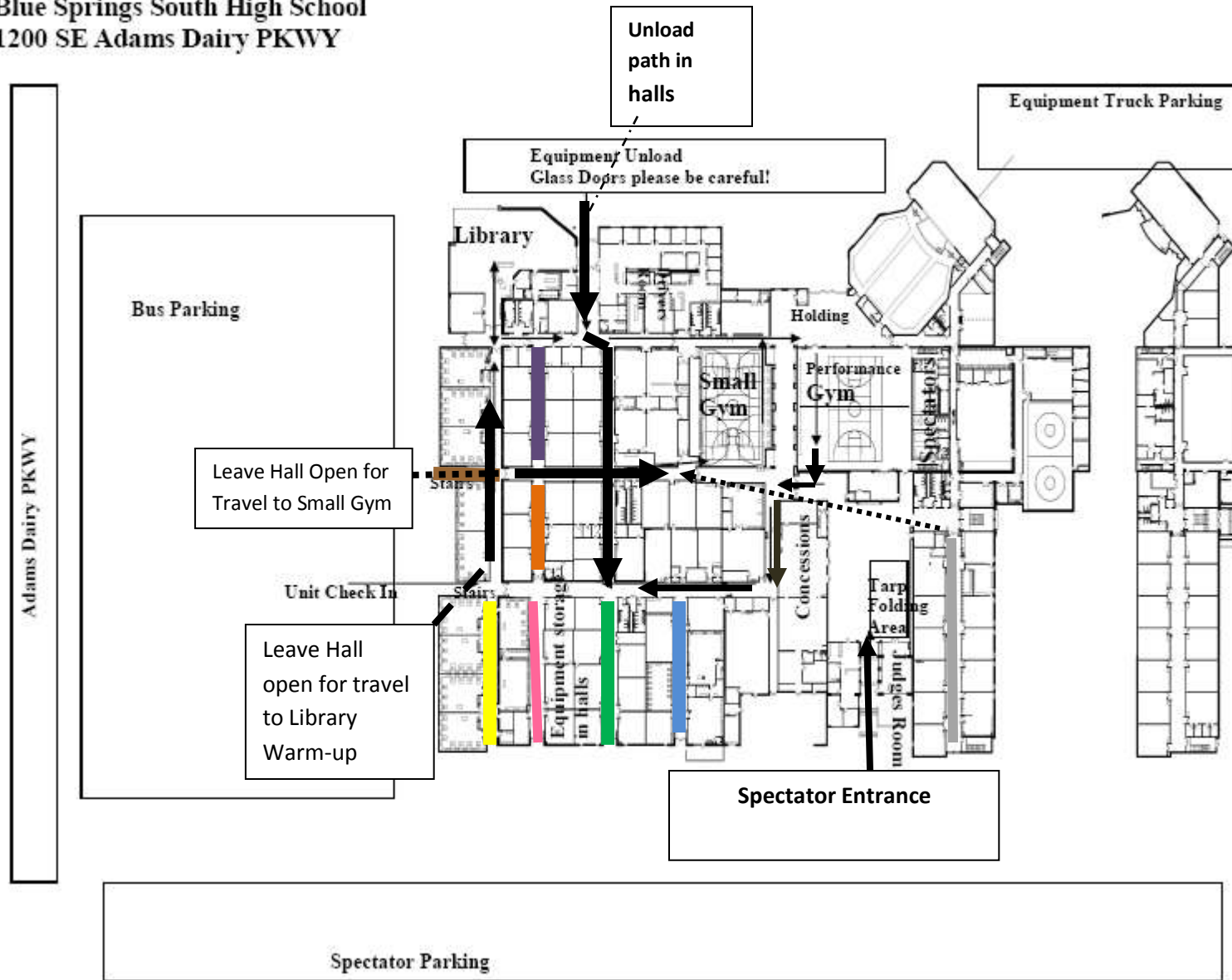

MCCGA Percussion Super Show-Hall Assignments

Due to the predicted snow we are going to try to locate all instruments in the halls and not ask groups to reload the trucks after each performance. Please ask the members to compact the instruments as much as possible and be respectful of other groups and the facilities. However, if you have large props that are going to fill the hall, we ask that you use common sense and reload the truck back onto the truck after your performance. There is only so much room in the building. Instruments are the first priority in the halls. Thank you!

Yellow Hall

1. Parsons
2. Center
3. Hillsboro

Pink Hall

1. Platte County
2. Joplin
3. Creston

Green Hall

1. Northwest
2. Odessa
3. Ozark

Blue Hall

1. Nixa
2. Parkview
3. Smith Cotton

Orange Hall

1. Webb City
2. Lee's Summit

Purple Hall

1. Francis Howell
2. The 402

Brown Hall

1. Harrisonville

Grey Hall***

2. Kickapoo
3. Gateway Percussion

***Because these groups go on later we thought we would try having you store your instruments in this hall. However, if there is room at the end of the day we will try placing you in a hall that does not go through the spectator locations.*

South Percussion

Band Room/Stage